

**THE COUNCIL OF THE BOROUGH OF MILTON KEYNES
(THE COUNCIL OF THE BOROUGH OF MILTON KEYNES)
(CENTRAL MILTON KEYNES) (ON-STREET STANDARD RATE
PAY AND DISPLAY AND PAY BY MOBILE PHONE PARKING
PLACES AND VARIOUS PERMITS) ORDER 2002) VARIATION
ORDER 2015 (No.2)**

The Council of the Borough of Milton Keynes (hereinafter referred to as "the Council") in exercise of their powers under Sections 45, 46, 49 and 53 and part IV of Schedule 9 of the Road Traffic Regulation Act 1984, ("the Act of 1984") and of all other enabling powers, and after consultation with the Chief Officer of Police in accordance with Part III of Schedule 9 to the Act of 1984, hereby makes the following Order:-

PART 1

IMPLEMENTATION AND CITATION

1. This Order shall come into operation on the 23rd day of July 2015 and may be cited as "The Council of the Borough of Milton Keynes (The Council of the Borough of Milton Keynes) (Central Milton Keynes) (On-Street Standard Rate Pay and Display and Pay by Mobile Phone and Various Permits) Order 2002) Variation Order 2015 (No.2)".
2. Any reference in this Order to any enactment shall be construed as a reference to that enactment as amended by any subsequent enactment.

PART 2

VARIATIONS

3. The Council of the Borough of Milton Keynes (Central Milton Keynes) (On-Street Standard Rate Pay and Display and Pay by Mobile Phone

and Various Permits) Order 2002 ("The Principal Order") is varied as provided by the following provisions of this Order:-

4. Item PS56b is revoked from 2 and inserted into Schedule 2B of the Principle Order
5. The following item LP19c is inserted into Schedule 3 of the Principle Order:-

MIDSUMMER BOULEVARD

THE NORTH-WEST VEHICULAR ACCESSWAY – NORTH-WEST SIDE

LP19c From the north-eastern kerb line of Upper Second Street to the south-western side of the porte cochere situated north-east of Upper Second Street

PART 3

REVOCATIONS

6. The following Order is HEREBY REVOKED to the extent stated below:-

THE COUNCIL OF THE BOROUGH OF MILTON KEYNES) (CENTRAL MILTON KEYNES) (ON-STREET STANDARD RATE PAY AND DISPLAY AND PAY BY MOBILE PHONE PARKING PLACES AND VARIOUS PERMITS) ORDER 2002

Item PS56c in Schedule 2B is HEREBY REVOKED IN ITS ENTIRETY;

Item LP19b in Schedule 3 is HEREBY REVOKED IN ITS ENTIRETY

**THE COMMON SEAL of the COUNCIL
OF THE BOROUGH OF MILTON
KEYNES** was hereunto affixed this 21st
day of July 2015 in the presence of:-

.....

HEAD OF LEGAL SERVICES

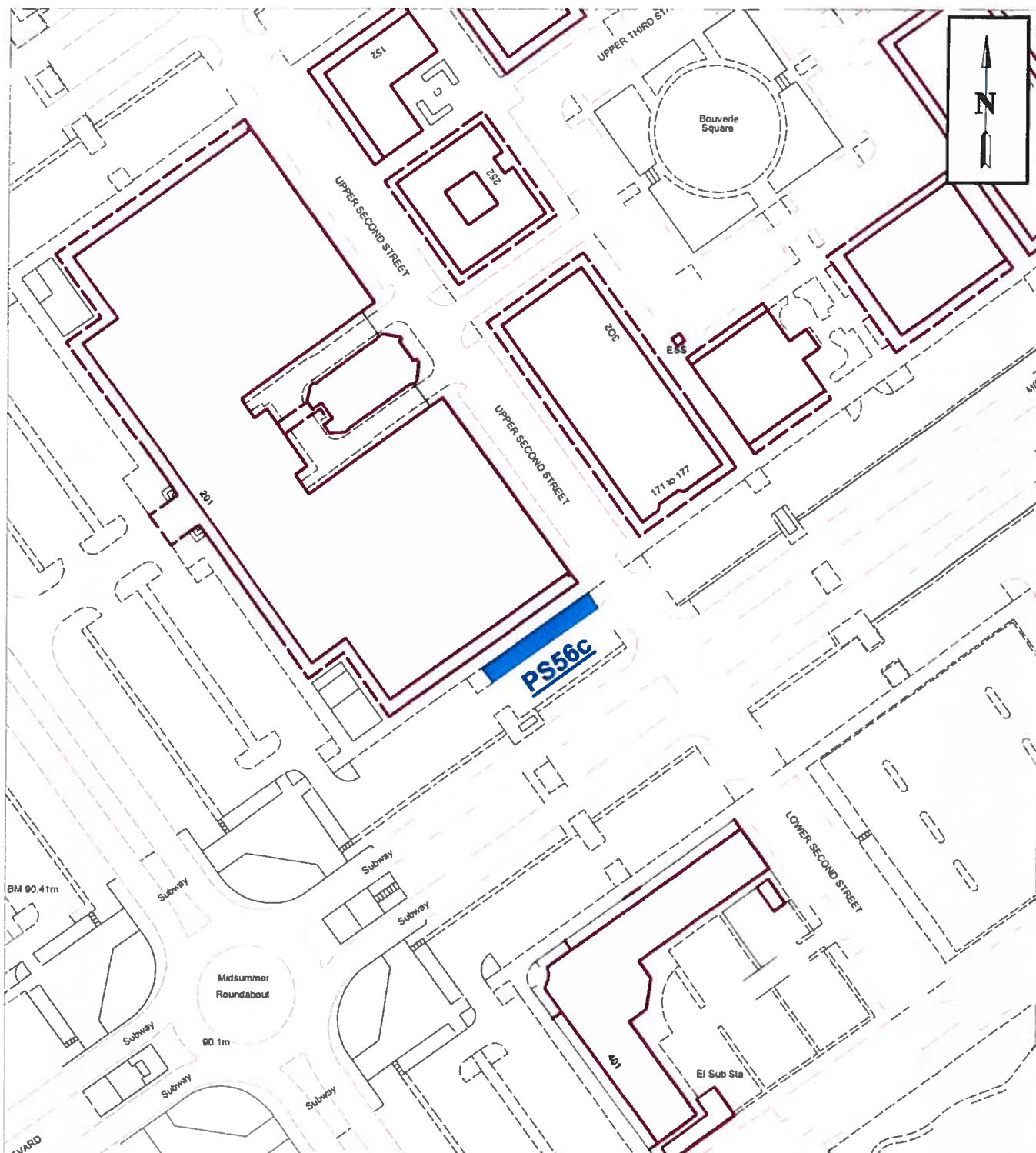

Standard rate pay and display parking places

PS56b

TRO reference

Map referred to in the Council of the Borough of Milton Keynes (The Council of the Borough of Milton Keynes) (Central Milton Keynes) (On-Street Standard Rate Pay and Display and Pay by Mobile Phone and Various Permits) Order 2002) Variation Order 2015 (No.2)

Map 1

The Common Seal of the Council of the Borough of Milton Keynes was hereunto affixed in the presence of:

.....
HEAD OF LEGAL SERVICES

0 6,047



centimeters

Scale: 1:2,016

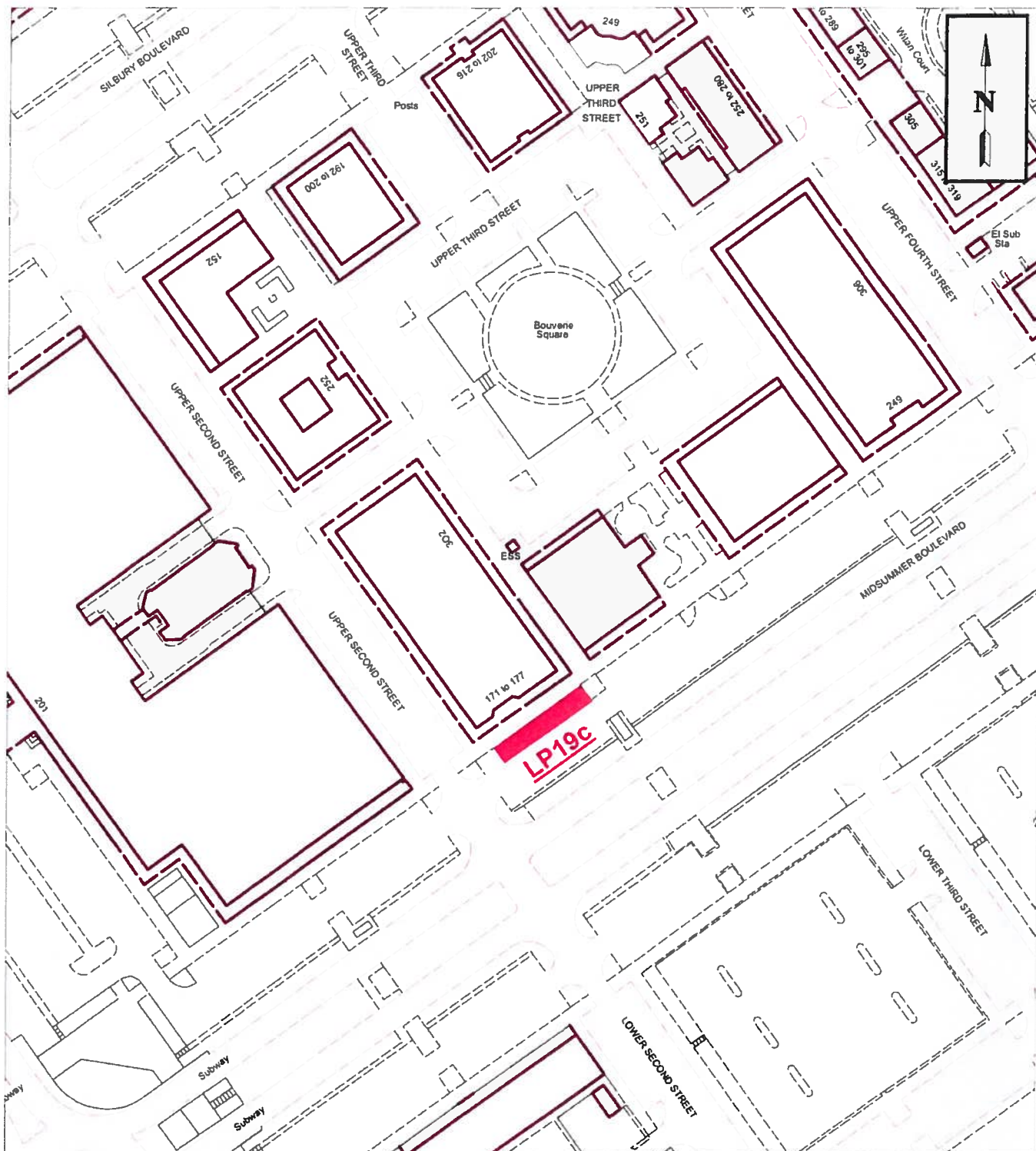

Limited parking for permit holders parking places

LP19c

TRO reference

Map referred to in the Council of the Borough of Milton Keynes (The Council of the Borough of Milton Keynes) (Central Milton Keynes) (On-Street Standard Rate Pay and Display and Pay by Mobile Phone and Various Permits) Order 2002) Variation Order 2015 (No.2)

Map 2

The Common Seal of the Council of the Borough of Milton Keynes was hereunto affixed in the presence of:

.....
HEAD OF LEGAL SERVICES

0 6,047
centimeters
Scale: 1:2,016

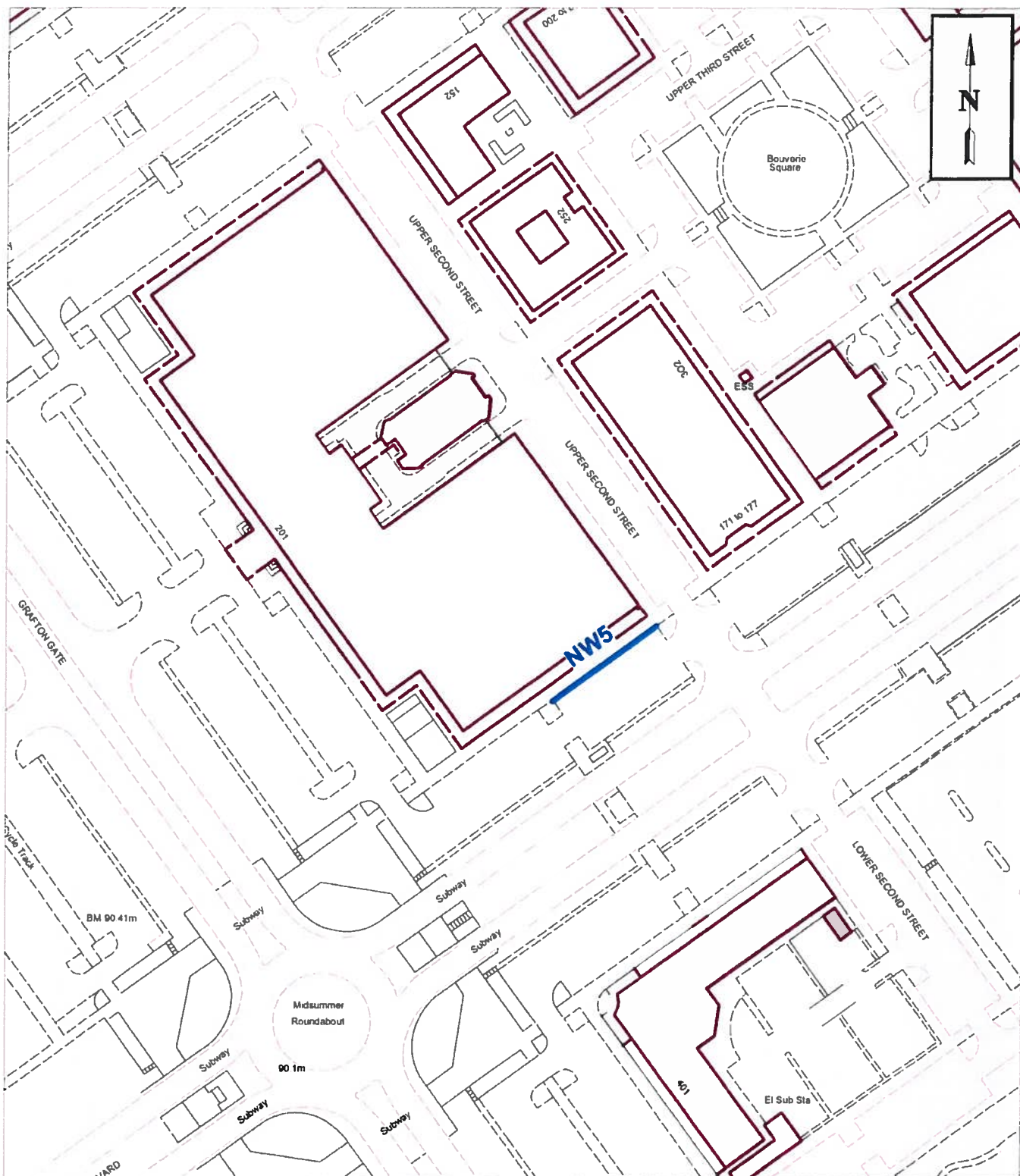

 **No Waiting (Between 7.00am and 9.15am)**

NW5 TRO reference

0 6,047

centimeters
Scale: 1:2,016

Map referred to in the Council of the Borough of Milton Keynes (The Council of the Borough of Milton Keynes) (Central Milton Keynes) (Prohibition of Waiting) Order 2015) Variation Order 2015

The Common Seal of the Council of the Borough of Milton Keynes was hereunto affixed in the presence of:

.....
HEAD OF LEGAL SERVICES